



**MANUFACTURER OF
PRE-ENGINEERED BUILDINGS**



AVLON
SUSTAINABLE FUTURE



CONTENT

ABOUT US	02
MISSION & VISION	04
AVLON PEB	06
BUILDINGS WITH MEZZANINES	08
CRANE BEAMS	10
STAIRCASE & JACK BEAM	12
TYPES OF FASCIAS & CANOPY DETAILS	14
FASCIAS AND CANOPIES	15
SECONDARY FRAMING	16
ROOFING & CLADDING SYSTEM	17
MANUFACTURING FACILITY	18
OUR MACHINERY	19
QUALITY ASSURANCE PROCEDURE	21
WE WORK WITH	22

HIGH QUALITY PRE-ENGINEERED STRUCTURES

ABOUT US

AVLON STRUCTURE PVT LTD (ASPL) is a leading high-Quality Pre-Engineered Building (PEB) solution provider with Committed to transforming the future of construction through innovation, precision, and excellence. Specializing in the design, manufacturing, and installation of high-quality steel structures.

We cater to a wide range of industries including warehouses, industrial sheds, commercial buildings, logistics parks, Multi-Storage building and more. AVLON STRUCTURE PVT LTD (ASPL) established in 2025 with the vision of delivering high-quality, robust, and efficient structural solutions. Strategically facility located in Ahmedabad, Gujarat. Our advanced manufacturing facility is equipped with modern and high-class machinery, ensuring precision and excellence in every component we produce.

At ASPL, we are dedicated to upholding the highest standards of quality in the pre-engineered building sector. Our expansive manufacturing facility, currently spread across 1,00,000 sq feet area. The production capacity of Primary Structure: 24,000 MT per annum and it's expandable up to 36,000 MT. ASPL has rapidly established a strong and diverse customer base across various sectors, including, Warehouses, Engineering, Pharmaceuticals, Chemical, Automobiles, Airports, Railways, Showrooms, Multi-story Buildings, Cold Storages, textiles and proudly supplies within India as well as Overseas Markets.

MISSION & VISION —

OUR MISSION



To deliver high-quality, innovative, and sustainable pre-engineered building solutions that prioritize efficiency, durability, and customer satisfaction.

OUR VISION



To lead the industry in sustainable, innovative, and adaptable pre-engineered building solutions that shape the future of construction.

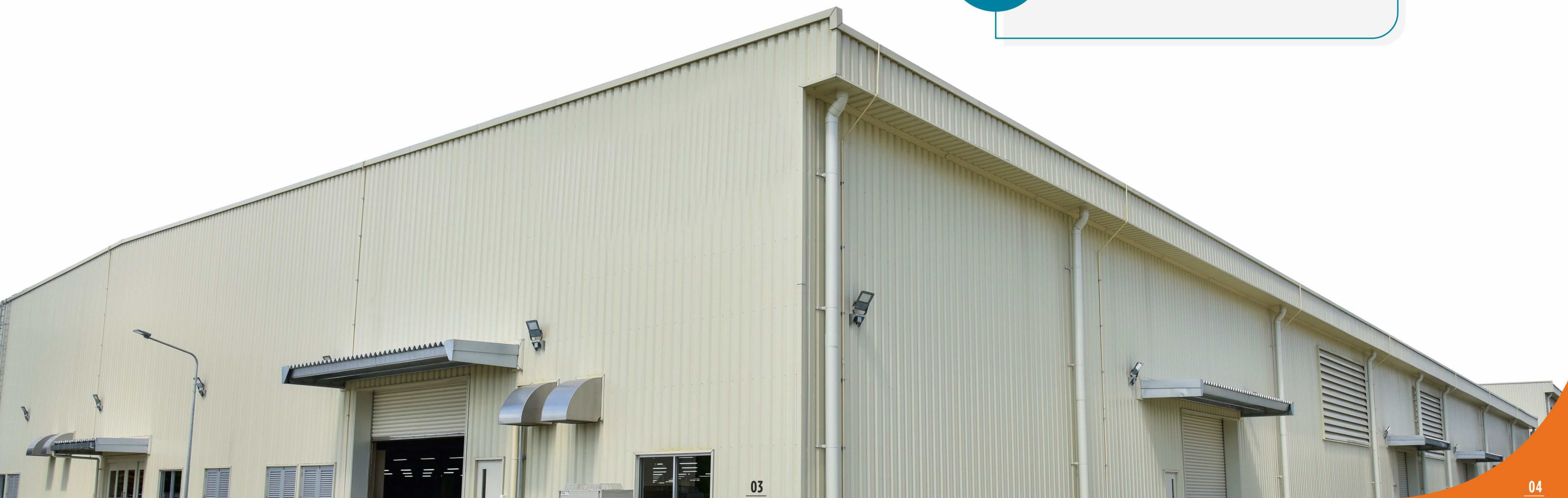

COMMITTED TO QUALITY

Avlon Structure Pvt Ltd (ASPL) deliver uncompromising quality in every facet of our Pre-Engineered Building (PEB) solutions. From meticulous design and engineering to the use of premium-grade materials and precise fabrication, our commitment ensures robust, durable, and efficient structures tailored to your exact needs. Our experienced team adheres to stringent quality control measures throughout the entire process, guaranteeing structural integrity, long-term performance and ultimately your complete satisfaction.

Our experienced engineers utilize cutting-edge software and adhere to the latest industry standards (including relevant Indian codes and IS standards) to create designs that are not only structurally sound and efficient, but also optimized for your specific functional requirements. We meticulously detail every component, ensuring seamless integration and minimizing on-site complications.

Our fabrication facilities employ advanced techniques and skilled technicians who adhere to strict quality control protocols at every step of the manufacturing process. This ensures dimensional accuracy, precise welding, and a superior finish for all structural members. Located within Gujarat, we maintain close oversight of the fabrication process.

We implement multi-stage inspections, from raw material verification to in-process checks during fabrication and before dispatch the material. This meticulous attention to detail minimizes errors and ensures that the final product meets our exacting standards and your expectations.

WHY AVLON PEB?

Avlon Structure Pvt Ltd (ASPL) stands out as a trusted partner in the pre-engineered building (PEB) industry, delivering customized and high-quality steel structures backed by advanced design and engineering with state-of-the-art software and precision detailing.

One of the core advantages of choosing ASPL is its ability to deliver faster and more efficiently. All structural components are fabricated at in house shop in a controlled environment. This streamlined process minimizes manpower, speeds up installation, and ensures timely project delivery. Quality and durability are embedded into every ASPL project. The company also focuses on sustainable practices and offering energy-efficient designs that support green building standards.

Our experienced erection teams follow best practices and safety guidelines for the on-site assembly of your PEB. We understand the importance of precise and efficient erection to maintain the integrity of the structure and ensure its long-term performance in the specific conditions. We provide comprehensive support throughout your project from initial consultation and design modifications to timely delivery and responsive after-sales service.

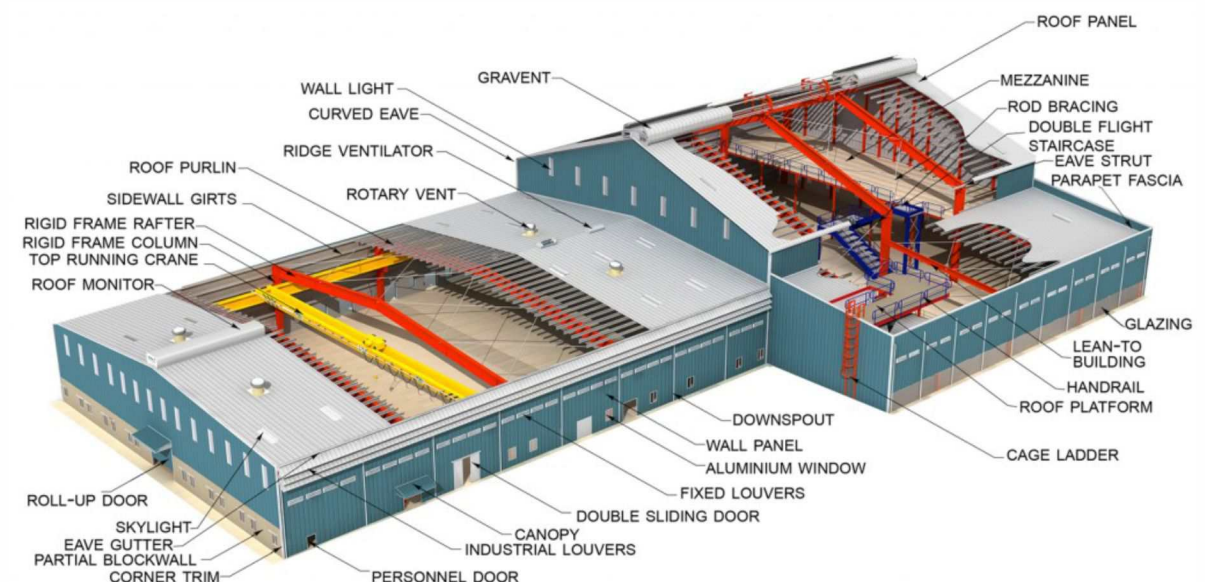

PRIMARY FRAMING (MAIN FRAME) —

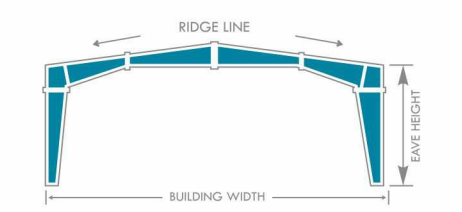

TAPERED COLUMN CLEAR SPAN (TCCS)

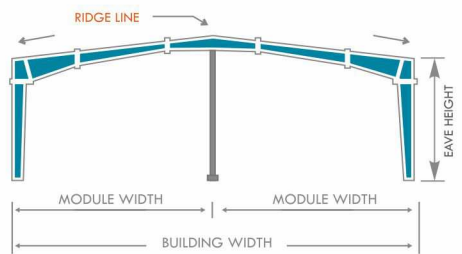

MULTI SPAN I

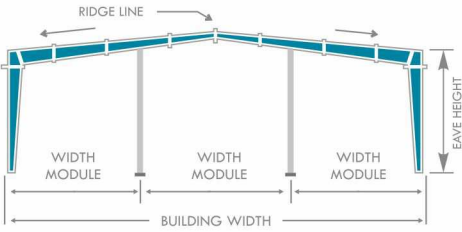

MULTI SPAN II

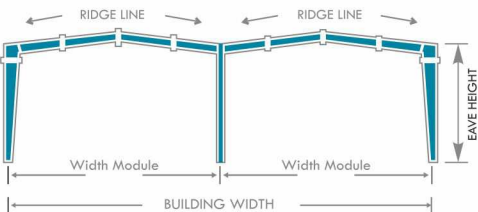

MULTI GABLE (MG) I / II

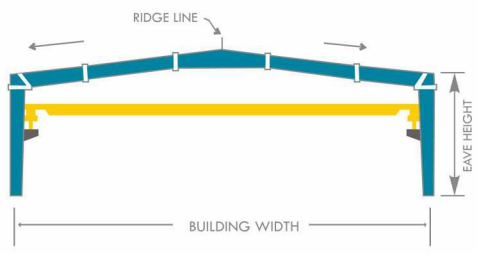

CLEAR SPAN WITH CRANE

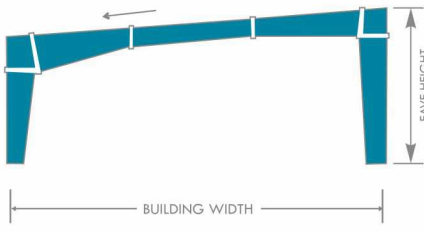

MONO SLOPE

BUILDINGS WITH MEZZANINES —

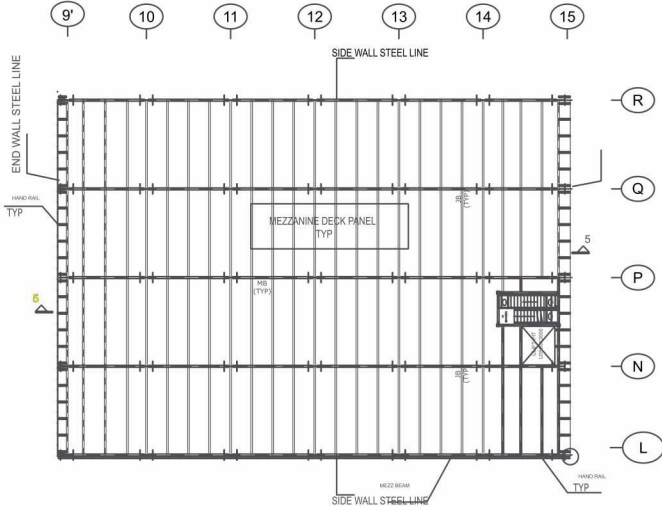

MEZZANINE PLAN

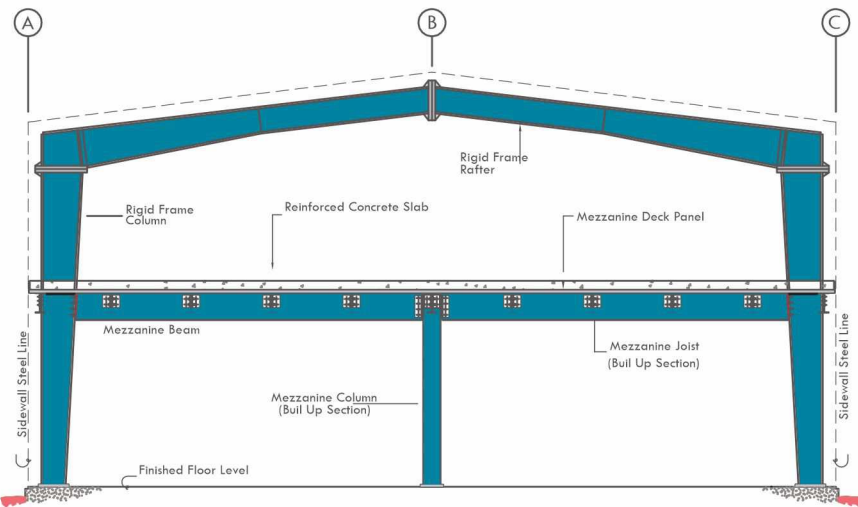

MULTI GABLE (MG) I / II

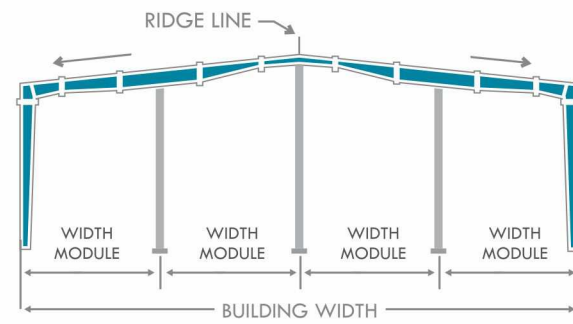

TAPERED COLUMN CLEAR SPAN (TCCS)

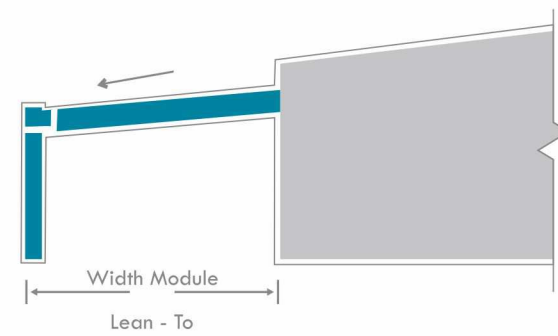

LEAN - TO

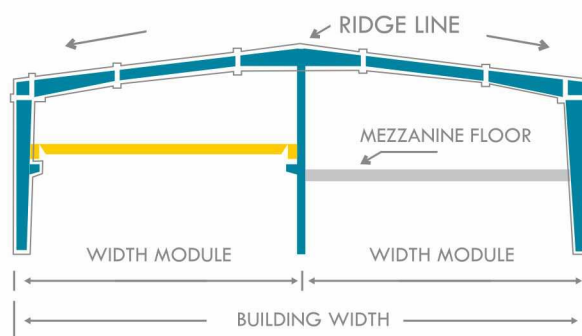

MULTI SPAN I WITH CRANE & MEZZANINE

CRANE BEAMS —

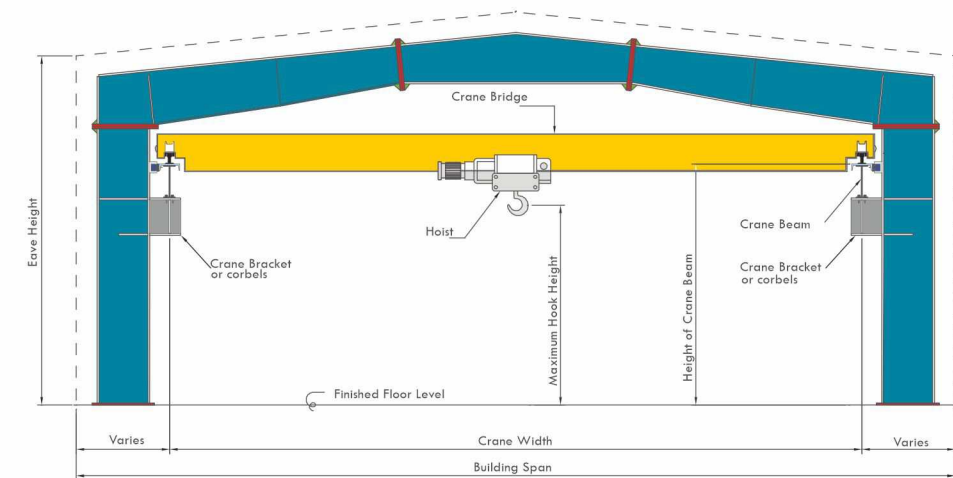

TOP RUNNING CRANE ALONG BUILDING LENGTH

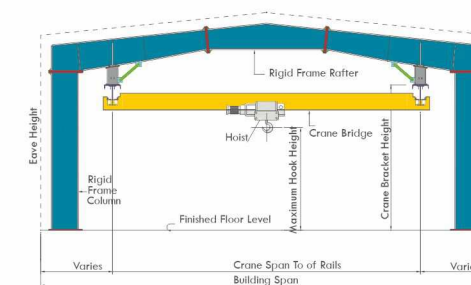

UNDERHUNG CRANE

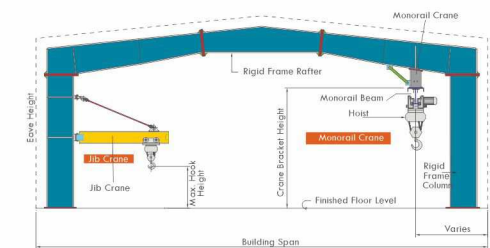

JIB CRANE AND MONORAIL CRANE

STAIRCASE DETAILS

SINGLE FLIGHT STAIRCASE

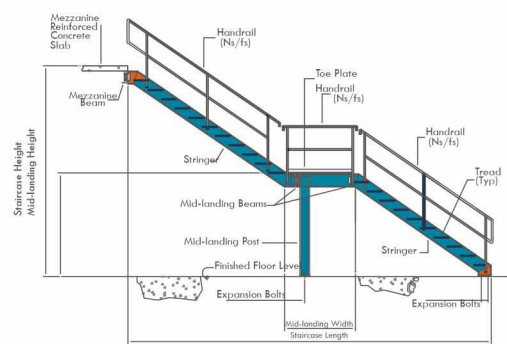

Elevation: Single Flight Staircase with Mid-landing

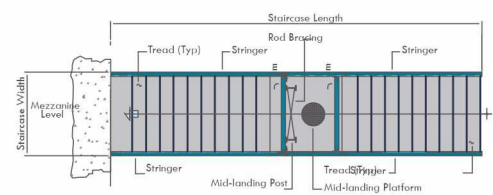

Plan: Single Flight Staircase with Mid-landing

DOUBLE FLIGHT STAIRCASE

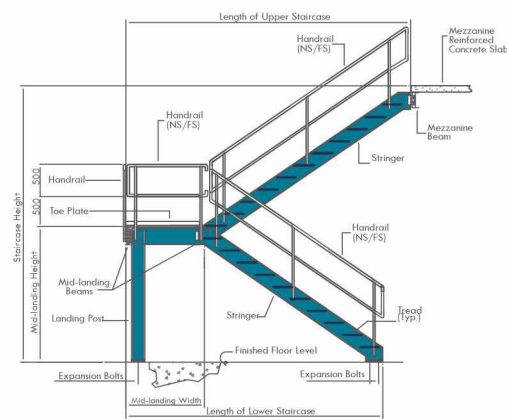

Elevation: Double Flight Staircase with Mid-landing

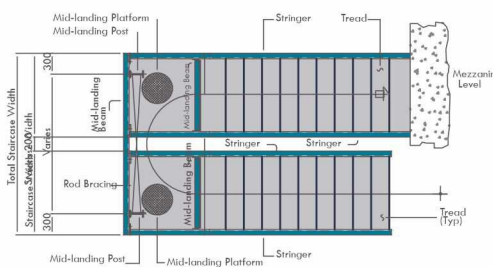

Plan: Single Flight Staircase with Mid-landing

JACK BEAM

ISOMETRIC: JACK BEAM AT SIDEWALL

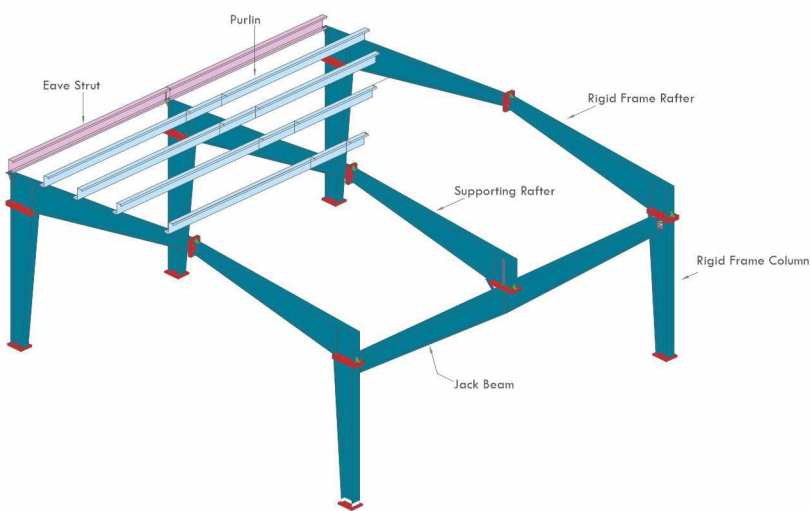

ISOMETRIC: JACK BEAM AT INTERIOR COLUMN LOCATION

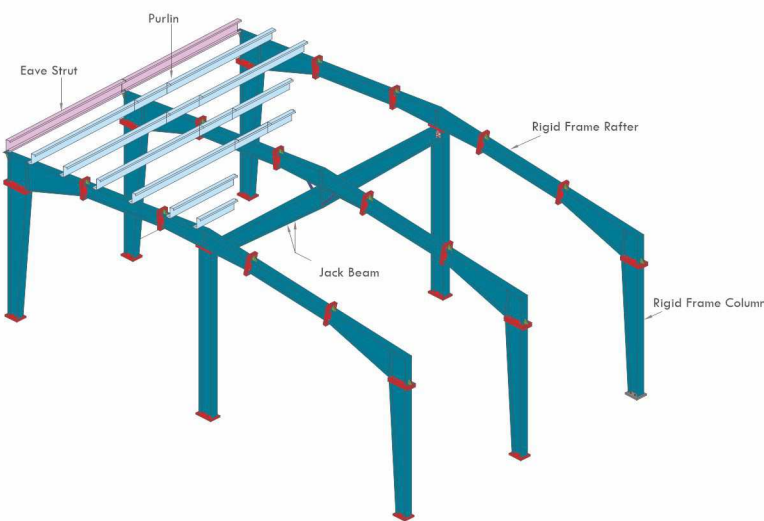

TYPES OF FASCIA —

FLUSH FASCIAS WITH EAVE GUTTER

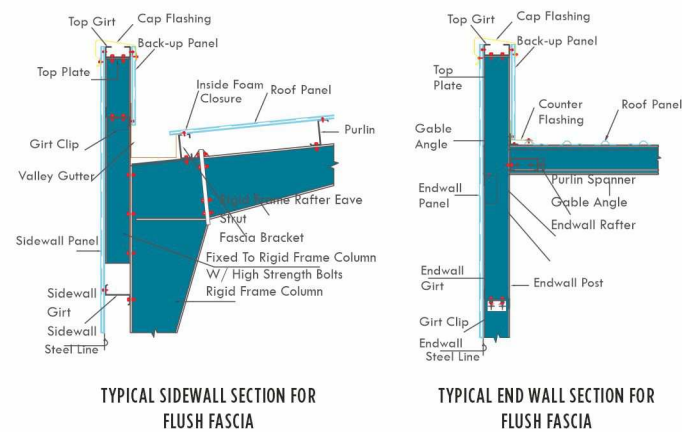

SECTION: BOTTOM CURVED FASCIA WITH VALLEY GUTTER

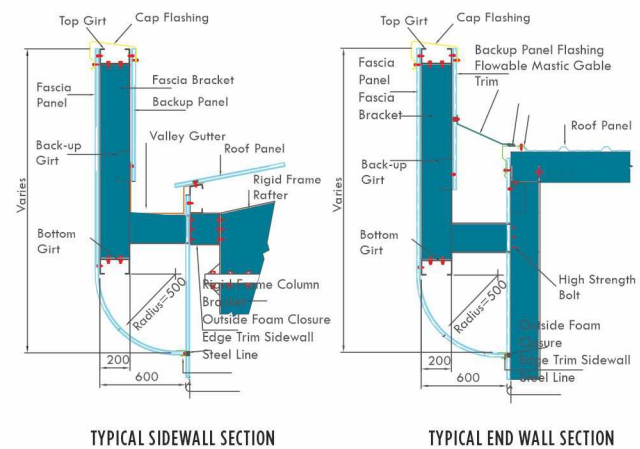

FLUSHED FASCIA OR PARAPET FASCIA

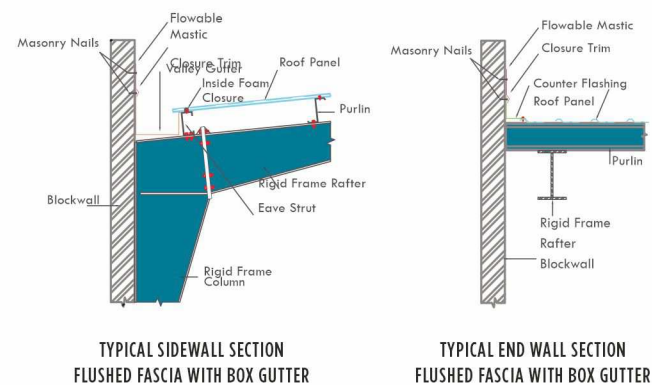

VERTICAL FASCIA WITH VALLEY GUTTER, BACK PANEL & SOFFIT

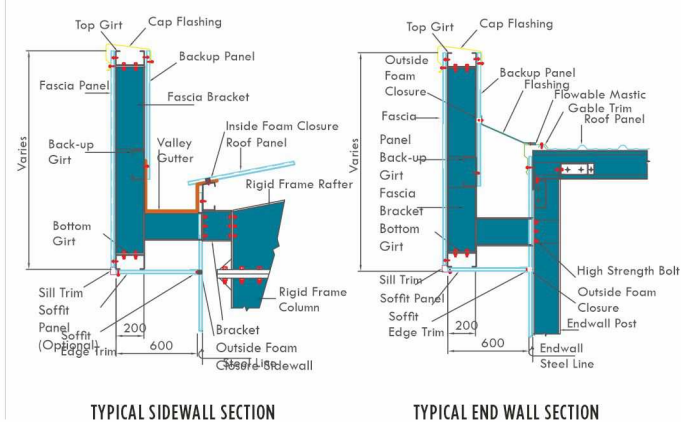

CANOPY DETAILS

ISOMETRIC : CURVED EAVES

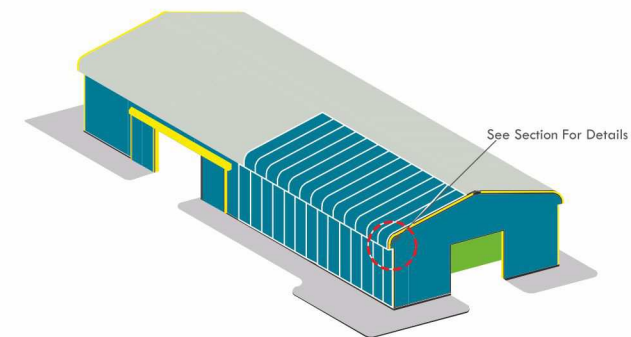

SECTION : CURVED EAVE

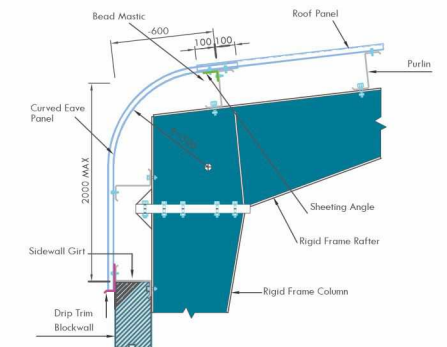

CANOPY WITH CURVED EAVES WITH BOTTOM SOFFIT

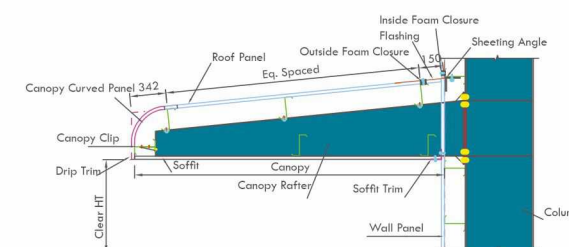

CANOPY WITH CURVED EAVES WITHOUT SOFFIT

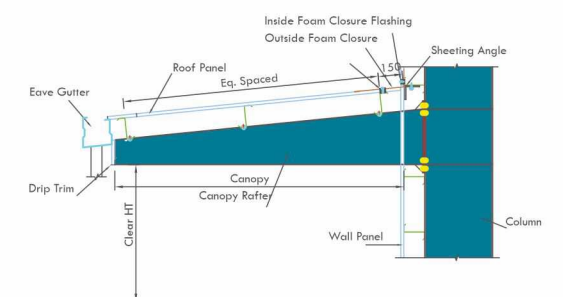

CANOPY WITH GUTTER & DOWNTAKE WITHOUT SOFFIT

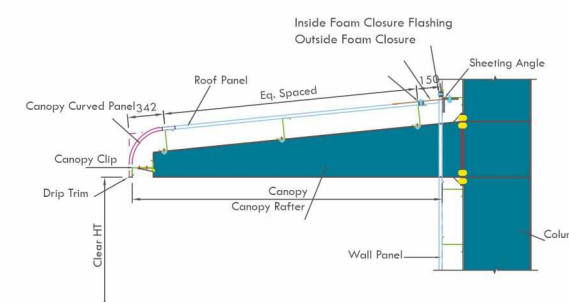

ROOF EXTENSION AT EAVE (WITH SOFFIT)

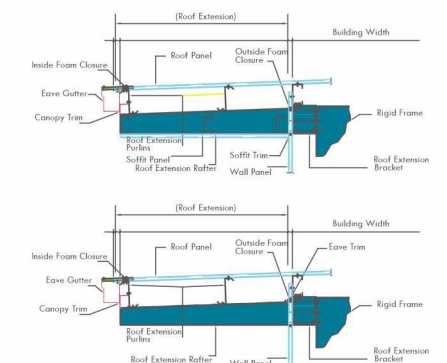

FASCIAS AND CANOPIES —

AVLON provides fascias specially designed to your requirements. These can be either vertical, horizontal or with curved sheeting to enhance the architectural look of your building. Wall canopies at eaves, end wall, over doors and windows are also available.



SECONDARY FRAMING (Z AND C SECTIONS) —

Purlins, girts and eave struts are cold formed steel members which have a minimum yield strength of 345 MPa (50,000 psi) and will conform to the physical specification of ASTM 572 (Grade 50) or ASTM A653 (Grade 50) or equivalent.

PURLINS & GIRTS

Purlins and girts are roll formed Z sections, 200 mm deep with 64 mm range shall have a 16 mm stiffening lip formed at 45 ° to the range. They are supported on columns, rafters or building walls. They can be lapped and nested at the supports which creates a continuous beam coagulation. They are placed on the roof and perimeter of the building. Hence they serve as a support to the roof sheeting and wall cladding.

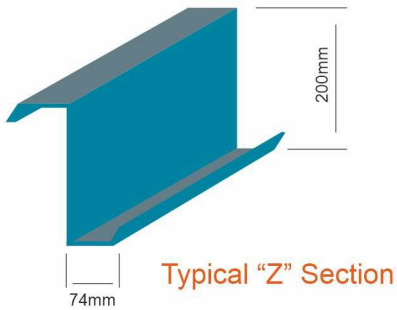

Typical “Z” Section

C SECTION

C-Sections are 200 mm deep with a 100 mm range. The ranges are perpendicular to the web and have a 24 mm stiffening lip.

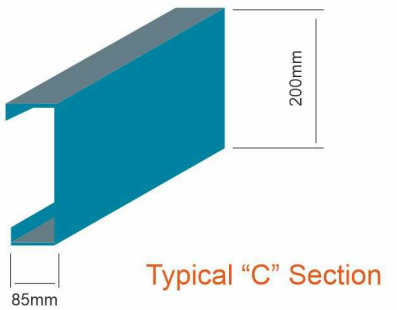

Typical “C” Section

EAVE STRUT

Eave struts are 200 mm deep with a 104 mm wide top range, a 118 mm wide bottom range, both are formed parallel to the roof slope. Each range has a 24 mm stiffener lip. These are located along the sidewall; at the intersection of the planes of the roof and wall. It is constructed from cold formed C-Section and is rolled to suit the roof slope. This member transmits longitudinal wind force on the end walls from roof brace rods to wall brace rods.

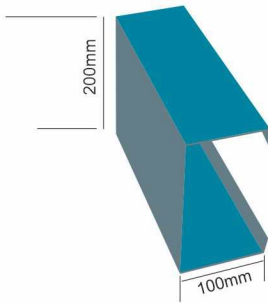

ROOFING & CLADDING SYSTEM —

AVLON ROOFING SYSTEM



AVLON standard steel panels are 0.5 mm or 0.6 mm thick and have a minimum yield strength of 345 MPa. Steel panels are hot dipped and galvanized with zinc or zinc aluminium coating. Galvanized materials conform to G90 for 275 grams per square metre according to ASTM A653. Zinc-Aluminium coated materials conform to AZ150 according to ASTM A792. AVLON panels are prepared with a multilayered coating system to ensure long life and optimum coating adherence. The base material is pretested, before applying a corrosion resistant primer and top coat. The combined thickness of the painted film is 25 microns on the front side and 12 microns on the reverse side.

AVLON CLADDING SYSTEM



MANUFACTURING FACILITY —

The factory manufactures first class quality building system components such as Columns, Beams, Purlins, Sheeting and Secondary structural items meant for Warehouses, Factories, Shopping Malls, Airports apart from structural members meant for refineries, oil and gas, High rise structures, Steel plants, Thermal plants etc. Structures even exported to various clients in countries like Middle East and Africa.

- OXY-FUEL PLASMA CUTTING MACHINE
- SHEARING MACHINE
- H-BEAM WELDING LINE
- MANUAL MIG WELDING MACHINE
- ARC WELDING MACHINE
- MAGNETIC BROCH CUTTER
- RADIAL DRILL MACHINE
- ANCHOR BOLT BENDER
- GRINDER MACHINES (7", 5", 4")
- OVERHEAD CRANES
- HYDRA CRANE
- SHOT BLASTING MACHINE
- PAINTING FACILITY
- AIRLESS SPRAY GUN
- Z-PURLIN FORMING MACHINE
- C-PURLIN FORMING MACHINE
- ROLL FORMING MACHINERY
- POWER PRESS
- SHEETING ACCESSORIES

OUR MACHINERY —

OXY-FUEL AND PLASMA
CUTTING MACHINE



HYDRAULIC
SHEARING MACHINE



ROLL
FORMING MACHINE



H-BEAM
WELDING LINE



CNC PUNCHING
MACHINE



CNC "C" & "Z"
PURLIN MACHINE



QUALITY ASSURANCE PROCEDURE —



WE WORK WITH

Factory :

 Plot No: 24-31, Parth Industrial Park, Kadi - Detroj Road,
Vill: Sadra, Ta: Kadi, Dist: Mehsana - 382715

Regd. Office:

 S/F 206, City Center 1, Thol Road, Near Fire Station,
Kadi - 382715 (N.G)

 +91 8200 54 2612

 info@avlonstructure.com  www.avlonstructure.com